

## 7 CATHEDRAL PARK

Downpatrick BT30 6GF

- Semi Detached House
- Four Bedrooms
- Living Room
- Kitchen with dining area
- Enclosed rear garden

Energy Efficiency Rating		Current	Potential
<i>Very energy efficient - lower running costs</i>			
(92 plus)	A		
(81-91)	B		
(69-80)	C		
(55-68)	D		
(39-54)	E		
(21-38)	F		
(1-20)	G		
<i>Not energy efficient - higher running costs</i>			
<b>Northern Ireland</b>			EU Directive 2002/91/EC

**Offers Around £195,000**

# 7 Cathedral Park

, Downpatrick, BT30 6GF



## Entrance Hall

Laminated wooden floor. Storage cupboard, stairs, door to: to rear, double doors to rear garden, door to:

## Living Room

15'11" x 11'10" (4.85m x 3.61m)  
Laminated wooden floor. Feature fireplace with tiled hearth. Two windows to side, window to front, door to:

## Kitchen/Dining Room

13'0" x 19'11" (3.96m x 6.07m)  
High and low level units with integrated electric oven and breakfast bar. Stainless steel sink unit. Tiled floor at kitchen and laminated wooden floor at dining area. tiled at splashback. Window

## WC

7'0" x 3'1" (2.13m x 0.95m)  
Window to front, door.

## Landing

## Bathroom

White panelled bath, low flush w.c., pedestal wash hand basin, shower cubicle with electric shower. Tiled floor. Tiled walls. Window to rear, door to:

## Bedroom 1

8'4" x 12'6" (2.53m x 3.81m)  
Window to rear, Storage cupboard, double door, door to:

## Bedroom 2

7'5" x 9'1" (2.26m x 2.77m)  
Window to side, door to:

## Bedroom 3

12'9" x 9'1" (3.89m x 2.77m)  
Laminated wooden floor. Window to front, Storage cupboard, double door, door to:

## Bedroom 4

9'3" x 10'6" (2.82m x 3.20m)  
Window to front, Storage cupboard, double door, door to:

## Outside

Gardens to the front in lawn with driveway. Enclosed rear garden in lawn and stoned area.

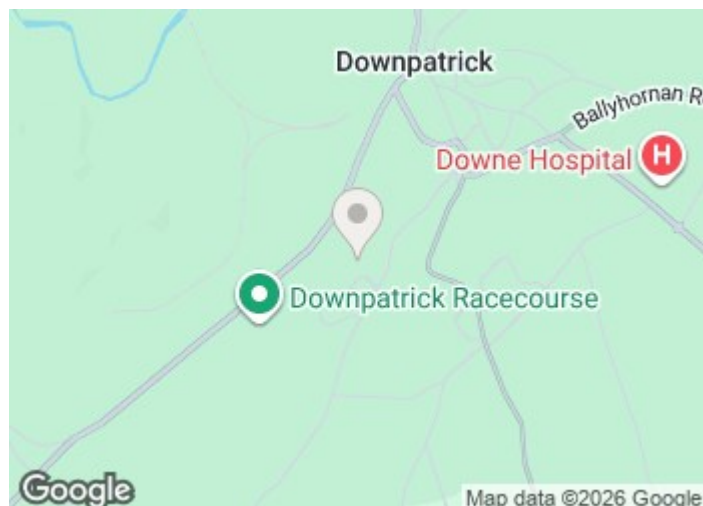

## Directions



# Floor Plan

## Ground Floor

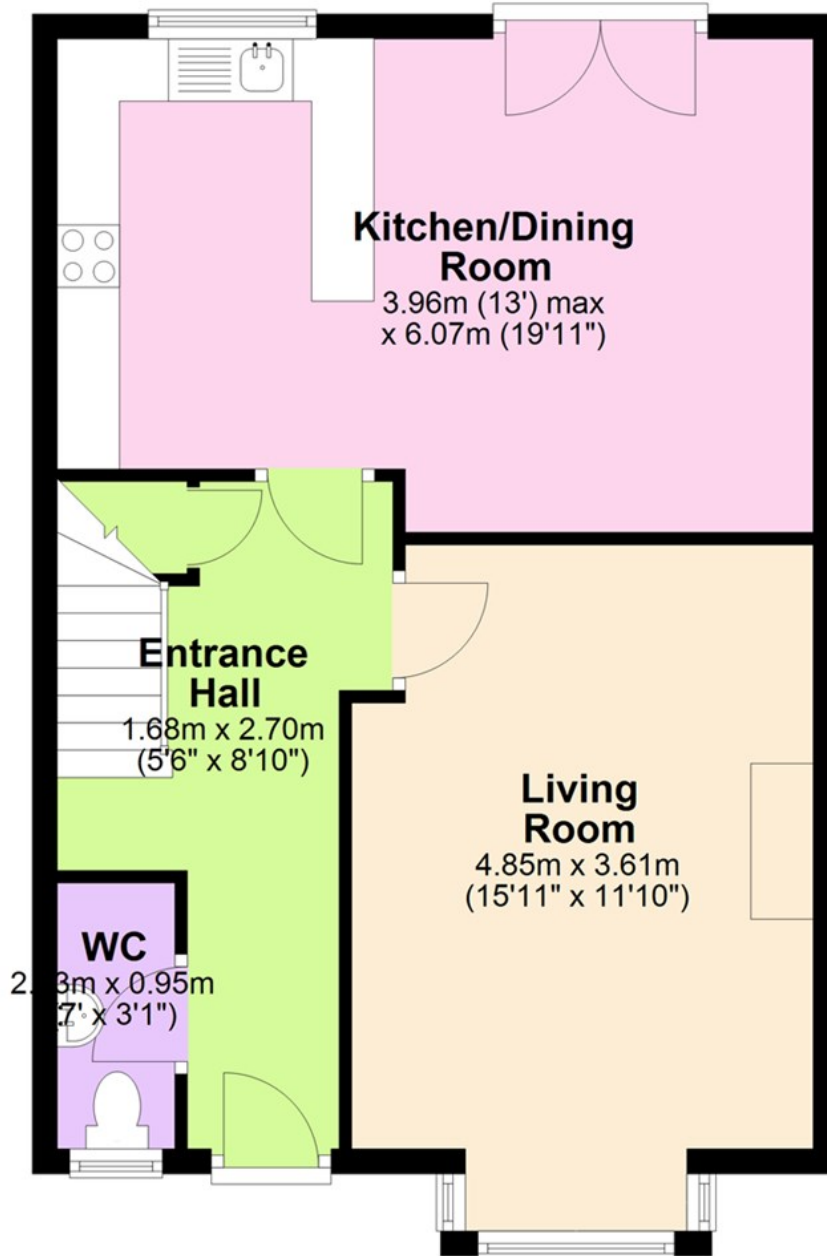

These particulars, whilst believed to be accurate are set out as a general outline only for guidance and do not constitute any part of an offer or contract. Intending purchasers should not rely on them as statements of representation of fact, but must satisfy themselves by inspection or otherwise as to their accuracy. No person in this firm's employment has the authority to make or give any representation or warranty in respect of the property.

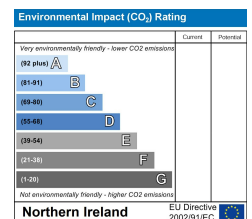
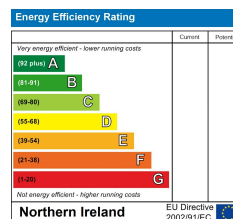

ULSTERPROPERTYSALES.CO.UK

**ANDERSONSTOWN**  
028 9060 5200  
**BALLYHACKAMORE**  
028 9047 1515  
**BALLYNAHINCH**  
028 9756 1155

**BANGOR**  
028 9127 1185  
**CARRICKFERGUS**  
028 9336 5986  
**CAVEHILL**  
028 9072 9270

**DONAGHADEE**  
028 9188 8000  
**DOWNPATRICK**  
028 4461 4101  
**FORESTSIDE**  
028 9064 1264

**GLENGORMLEY**  
028 9083 3295  
**MALONE**  
028 9066 1929  
**NEWTOWNARDS**  
028 9181 1444

**RENTAL DIVISION**  
028 9070 1000



John Thompson trading under licence as Ulster Property Sales (Downpatrick)  
©Ulster Property Sales is a Registered Trademark