



J. A. McClelland & Sons

Estate Agents • Auctioneers • Valuers • Rural & Land Agents

FOR SALE
STRAID ROAD,
GRACEHILL, BALLYMENA



CIRCA 29.16 ACRES OF GOOD QUALITY AGRICULTURAL LAND
(Available in one or two lots)

A compact parcel of land extending to circa 29.16 acres of good quality agricultural land. The holding has excellent frontage to the Straid Road and also benefits from a shared access lane bounding one side of the lands. Fields are well fenced and watered for stock with thick mature hedgerows providing good shelter. BPS entitlements available by separate negotiation. Early inspection is highly recommended.

PRICE: O.I.R.O. £400,000

VIEWING: Anytime

www.jamcclelland.com

MAP

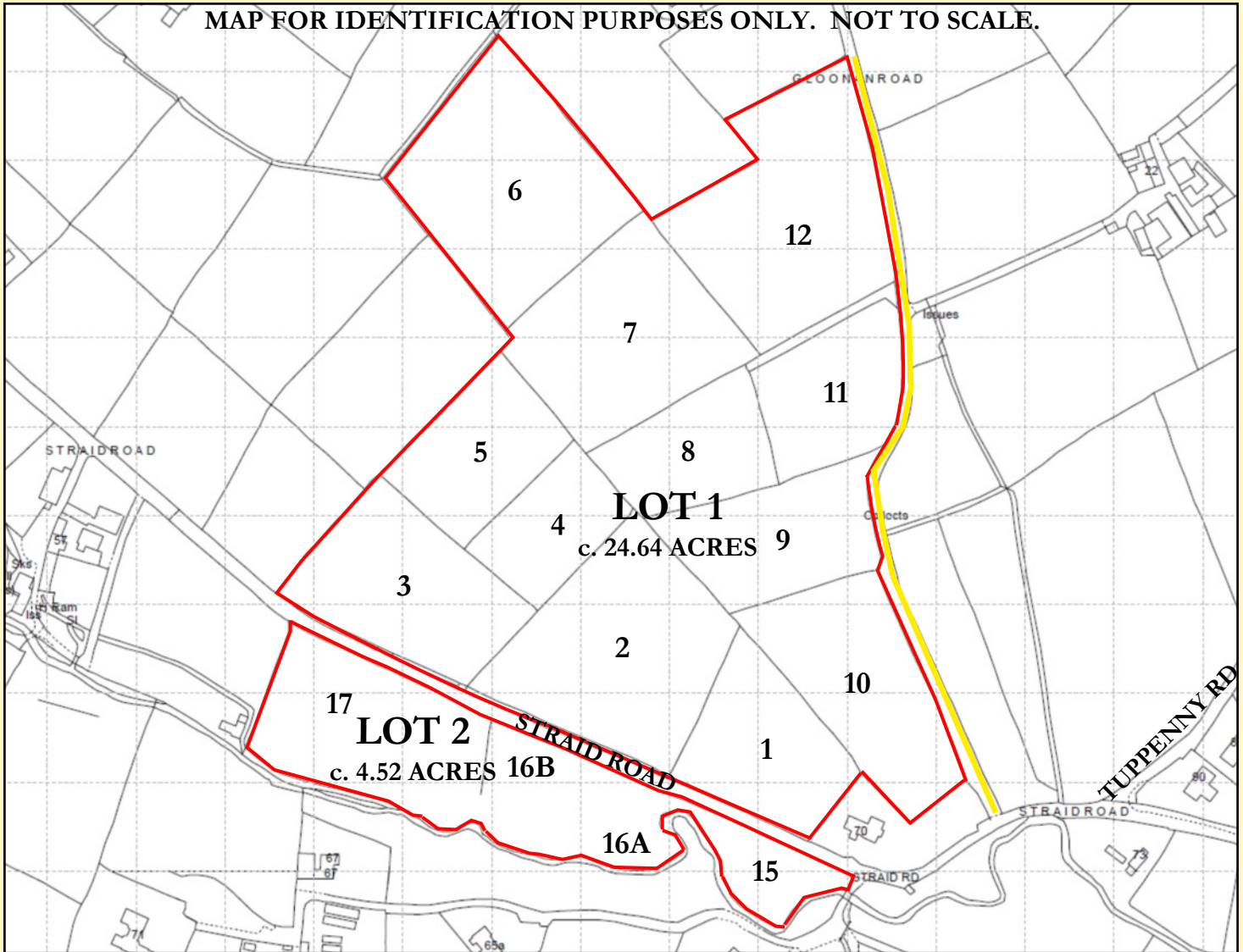

TITLE: Title enquiries to Karen Burke of
McKervill Neilly Solicitors, Ballymena.



J. A. McClelland & Sons

Estate Agents • Auctioneers • Valuers • Rural & Land Agents
Ballymena Livestock Market, Unit 1 Woodside Road,
Ballymena, Co. Antrim BT42 4QJ

Tel: 028 2563 3470 Email: sales@jamcclelland.com

www.jamcclelland.com

AGENT'S NOTES

J A McClelland & Sons Ltd and their clients give notice that:

1. They have no authority to make or give any representations or warranties in relation to the property.
2. These particulars have been prepared in good faith to give an overall view of the property, they do not form any part of an offer or contract, and must not be relied upon as statements of representations of fact.
3. Any areas, measurements or distances are approximate. The text, photographs and plans are for guidance only and are not necessarily comprehensive. It should not be assumed that the property has all necessary planning, building regulation or other consents and J A McClelland & Sons Ltd have not tested any services, equipment or facilities. Purchasers must satisfy themselves by inspection or otherwise.

Field Number	Hectares	Acres
1	0.67	1.65
2	1.19	2.94
3	0.87	2.14
4	0.41	1.01
5	0.59	1.45
6	1.25	3.08
7	1.04	2.56
8	0.55	1.35
9	0.68	1.68
10	0.88	2.17
11	0.58	1.43
12	1.29	3.18
15 (wood)	0.27	0.66
16A (wood)	0.36	0.88
16B	0.27	0.66
17	0.94	2.32

(DAERA measure 2025)