

Outside

Gardens in lawn to front and enclosed pebbled garden to rear with patio and bunker storage. Driveway parking for multiple cars.

TEMPLETON
ROBINSON

TEMPLETON
ROBINSON



This superbly presented semi detached home offers bright, stylish accommodation designed for modern living.

Immaculately maintained throughout, it provides both comfort and practicality, making it an exceptional choice for a variety of buyers.

The property enjoys a highly convenient location, with well regarded local schools, shops, and excellent public transport links all just moments away.

Combining a sought-after setting with a high standard of finish, this impressive home is sure to attract strong interest, and early viewing is strongly recommended.

Offers Over
£165,000

16 St Marks Wood,
LISBURN ,
BT28 3AQ

Viewing by
appointment with
& through agent
028 9266 1700

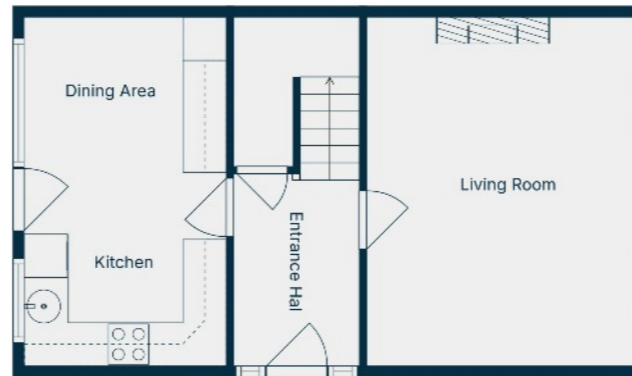
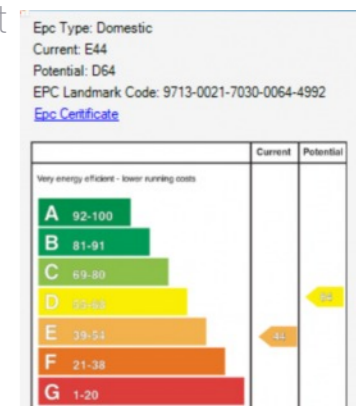

1st Floor



2nd Floor

Lisburn - 028 92 66 1700
Ballyhackamore - 028 90 65 0000
Lisburn Road - 028 90 66 3030
North Down - 028 90 42 4747

www.templetonrobinson.com

MONEY LAUNDERING REGULATIONS: Intending purchasers will be asked to produce identification documentation and we would ask for your co-operation in order that there will be no delay in agreeing the sale.

These particulars do not constitute any part of an offer or contract. None of the statements contained in these particulars are to be relied on as statements or representations of fact and intending purchasers must satisfy themselves by inspection or otherwise to the correctness of each of the statements contained in these particulars. The Vendor does not make or give, neither Templeton Robinson, nor any person in its employment has any authority to make or give, any representation or warranty whatever in relation to this property. All dimensions are taken to nearest 3 inches.



16 ST MARKS WOOD,
LISBURN ,
BT28 3AQ

Property Features

Superbly Presented Semi Detached Home
Finished To A High Standard Throughout

Bright And Stylish Accommodation Designed For
Modern Living

Spacious Dining Kitchen With Integrated
Appliances

Three Well Proportioned Bedrooms

Family Bathroom Featuring A Contemporary Three-
Piece Suite

Gas Fired Central Heating System and Double
Glazed Windows

Immaculately Maintained, Offering Both Comfort
And Practicality

Off Street Parking For Added Convenience

Attractive Front Garden Laid In Lawn And Enclosed
Rear Pebbled Garden

Quiet Cul De Sac Location Ideal For Families And
Professionals

Excellent Proximity To Local Schools, Shops,
Public Transport, And Easy Commuter Access To
Belfast

Location:

Travelling away from Lisburn on the Prince William Road,
continue past Knockmore Road turn and take next left into
Ballymacash Road. St Marks Wood is first turn on the right and
number 16 is in the first cul-de-sac on right hand side.

Property Comprises

Ground Floor

uPVC front door with glass sidelight to . . .

ENTRANCE HALL: 8' 9" x 5' 9" (2.67m x 1.75m) Ceramic tiled floor,
understairs storage.

LOUNGE: 15' 10" x 12' 4" (4.83m x 3.76m) Feature fireplace with
wooden surround (??????????????).

KITCHEN: 9' 2" x 8' 10" (2.79m x 2.69m) Range of high and low
level units, circular sink unit, plumbed for washing machine, oven
and four ring ceramic hob, stainless steel splashback, circular sink
unit, fridge freezer, ceramic tiled floor, access to rear.

First Floor

LANDING: Storage cupboards, access to roofspace.

BEDROOM (1): 15' 6" x 12' 4" (4.72m x 3.76m) Laminate wood
effect floor, built-in wardrobes, Velux window.

BEDROOM (2): 12' 4" x 10' 0" (3.76m x 3.05m) Laminate wood
effect floor, built-in wardrobes, Velux window.

BEDROOM (3): 9' 7" x 9' 2" (2.92m x 2.79m) Laminate wood effect
floor, Velux window.

BATHROOM: Comprising panelled bath with shower over, low
flush wc, wash hand basin with mixer tap, chrome heated towel rail,
fully tiled walls, tiled floor, extractor fan.

