

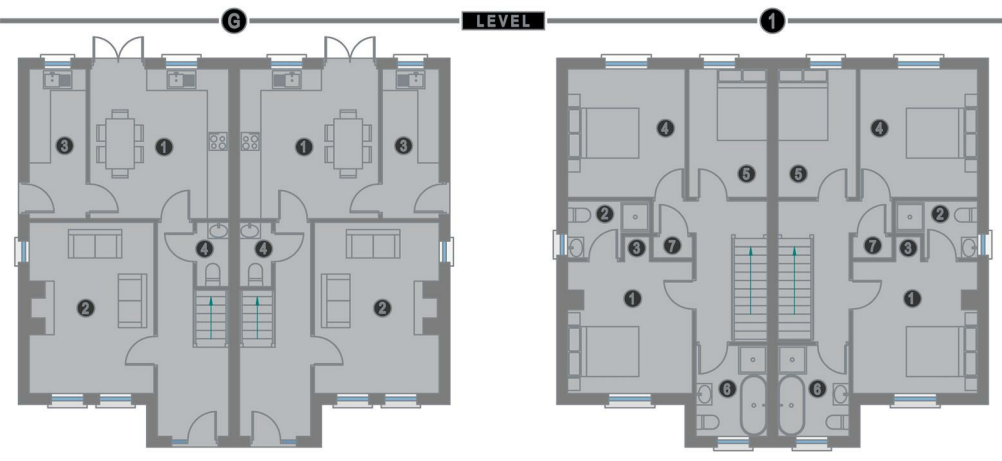

FOREST CLOSE HOUSE TYPE C



- GROUND FLOOR**
- 1. KITCHEN / DINING (4.2m x 3.9m)
 - 2. LOUNGE (4.6m x 3.6m)
 - 3. UTILITY (4.2m x 1.6m)
 - 4. W.C. (1.6m x 0.9m)

- FIRST FLOOR**
- 1. MASTER BEDROOM (3.7m x 3.1m)
 - 2. ENSUITE (2.3m x 1.6m max)
 - 3. WARDROBE (0.7m x 0.6m)
 - 4. BEDROOM 2 (3.6m x 3.3m)
 - 5. BEDROOM 3 (3.6m x 2.2m)
 - 6. BATHROOM (2.5m x 2m)
 - 7. HOT PRESS (1.1m x 0.6m)



**3 Bed
House - Semi-Detached
located in**



**Postal 76 Forest Close
Pomeroy
BT70 2BT**



Altmore Developments provide high quality homes. The local established company takes great pride in offering homes of quality and distinction, with the highest levels of specification besides offering an excellent customer care service and ultimately achieving highest customer satisfaction.

Altmore Developments invests much time and effort in carefully choosing sites and designing homes which are functional with generous living space, but at the same time are also beautifully finished both inside and out.

LOCATION:

Forest Close, located in the picturesque Village of Pomeroy. This is a perfect opportunity for families, couples and professional individuals to own a beautifully finished homes in a setting that offers the charm of a countryside feel combined with the ease of Village living.

The development of Forest Close border the countryside greenbelt and along with the expansive internal greenspace and landscaping provides additional buffers, it will certainly have a countryside feel. In all, the relaxed layout of the development creates an attractive, secure and rural feel.

GUARANTEE:

Global Home Warranty - 10 Years

Photographs attached are of a recent completion - please note this home had some upgrades.

VIEWING:

To arrange a viewing contact Connor Harte Ltd 028 8676 3265.

Price £210,000



Energy Efficiency Rating		
	Current	Potential
<i>Very energy efficient - lower running costs</i>		
(92 plus) A		
(81-91) B		
(69-80) C		
(55-68) D		
(39-54) E		
(21-38) F		
(1-20) G		
<i>Not energy efficient - higher running costs</i>		
Northern Ireland	EU Directive 2002/91/EC	

DIRECTIONS

CONTACT

7 to 9 Molesworth Street
Cookstown
Tyrone
BT80 8NX

E: connor@connorharte.com

T: 02886763265

connorharte.com

