



House Type K Cumber View Derry / Londonderry,



These perfectly situated 5 bedroom detached homes tick all the boxes for a growing family.

With a wide range of high quality external and internal features such as off street parking, private rear garden, paved patio and walkways, front door lighting, built in kitchen, selection of tiling and carpets throughout, ample storage space, tv points in bedrooms, Cat5 internet points.

Type K is a versatile family home with 2 large reception rooms, 5 bedrooms (2 with ensuite), dressing rooms, walk-in-wardrobes and a home office.

Cumber View offers the very best of suburban living, being just minutes away from local amenities and leisure facilities. This modern development is a 15min commute from Derry/Londonderry making it the ideal choice for your new home.

Cumber View is the perfect choice if you are looking for privacy, comfort and peace of mind. Fyth developments are one of Northern Ireland's top residential home builders.

AVAILABLE SITES:

- Site 27
- Site 28

No Price

Viewing

Please contact our Homepage Estate Agents Office on 028

7187 6261

if you wish to arrange a viewing appointment for this property or require further information.

- 5 BEDROOM FAMILY HOME
- 2 RECEPTION ROOMS
- 4 BATHROOMS
- FEATURE SUN ROOM
- 2 ENSUITE BEDROOMS
- 2 DRESSING ROOMS
- WALK-IN-WARDROBES
- STUNNING INTERNAL SPECIFICATION
- SOUGHT AFTER LOCATION

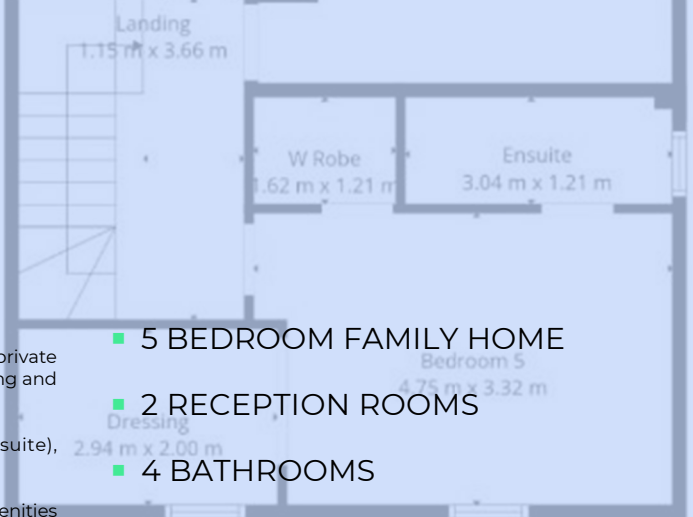

FIRST FLOOR





Energy Efficiency Rating		
	Current	Potential
Very energy efficient - lower running costs		
(92 plus) A		
(81-91) B		
(69-80) C		
(55-68) D		
(39-54) E		
(21-38) F		
(1-20) G		
Not energy efficient - higher running costs		
England & Wales		EU Directive 2002/91/EC
Environmental Impact (CO ₂) Rating		
	Current	Potential
Very environmentally friendly - lower CO ₂ emissions		
(92 plus) A		
(81-91) B		
(69-80) C		
(55-68) D		
(39-54) E		
(21-38) F		
(1-20) G		
Not environmentally friendly - higher CO ₂ emissions		
England & Wales		EU Directive 2002/91/EC



These particulars, whilst believed to be accurate are set out as a general outline only for guidance and do not constitute any part of an offer or contract. Intending purchasers should not rely on them as statements of representation of fact, but must satisfy themselves by inspection or otherwise as to their accuracy. No person in this firms employment has the authority to make or give any representation or warranty in respect of the property.