



## 51 Jerusalem Street, Ormeau Road, Belfast, BT7 1QN

**Asking Price £139,950**

Jerusalem street is located just off the lower Ormeau road and is only a few minutes walk from Queens University. With its convenient location to all the university facilities, shops, cafes and bars on Botanic avenue and Belfast city centre only a short distance away, you can be sure that all your daily needs are never far away.

The property itself is a traditional red brick, end terrace home that comprises of three double bedrooms, two reception rooms, modern fitted kitchen and white bathroom suite. The property also benefits from gas fired central heating and upvc double glazing throughout.

With its central location and spacious accommodation, this will make a fantastic first time purchase and/or investment so we recommend that you arrange a viewing at your earliest convenience so as not to miss out!

- Red Brick End Terrace Home
- Two Reception Rooms
- White Bathroom Suite
- Upvc Double Glazing
- Chain Free Sale
- Three Double Bedrooms
- Modern Fitted Kitchen
- Gas Fired Central Heating
- Enclosed Rear Yard
- Excellent First Time Purchase / Investment Opportunity

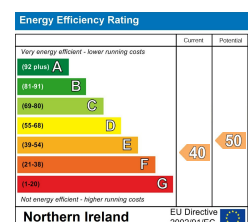

## Entrance Hall



Glazed upvc door with fan light opens on entrance hall with wooden effect vinyl flooring.

## Lounge 9'3" x 8'6" (2.82m x 2.60m)



Access to gas boiler.

## Dining Room 10'8" x 9'1" (3.26m x 2.78m)





### **Modern Fitted Kitchen 11'7" x 8'9" (3.55m x 2.69m)**



Modern fitted kitchen with a selection of upper and lower level shaker style units complete with wooden effect countertop, stainless steel sink with drainer, integrated oven with electric hob and overhead stainless steel extractor fan. Part tiled walls and wooden effect vinyl flooring. Access to under stair storage. Glazed upvc door opens onto enclosed rear yard.

### **First Floor**

### **Bedroom 1 12'1" x 9'3" (3.69m x 2.82m)**



### **Bedroom 2 11'7" x 8'10" (3.54m x 2.70m)**



(measurements at widest points)

### **White Bathroom Suite 10'8" x 7'0" (3.26m x 2.14m)**



White bathroom suite comprising of panelled bath, corner shower cubicle with pvc wall panelling, pedestal wash hand basin, low flush w.c and built-in storage cupboard. Part tiled walls and wooden effect vinyl flooring.

### **Second Floor**

**Bedroom 3 12'0" x 14'1" (3.67m x 4.30m )**



(measurements at widest points) Access to eaves storage.

**Enclosed Rear Yard**

Enclosed rear yard bordered by tall red brick wall. Access to rear gated alley.

Floor Plan

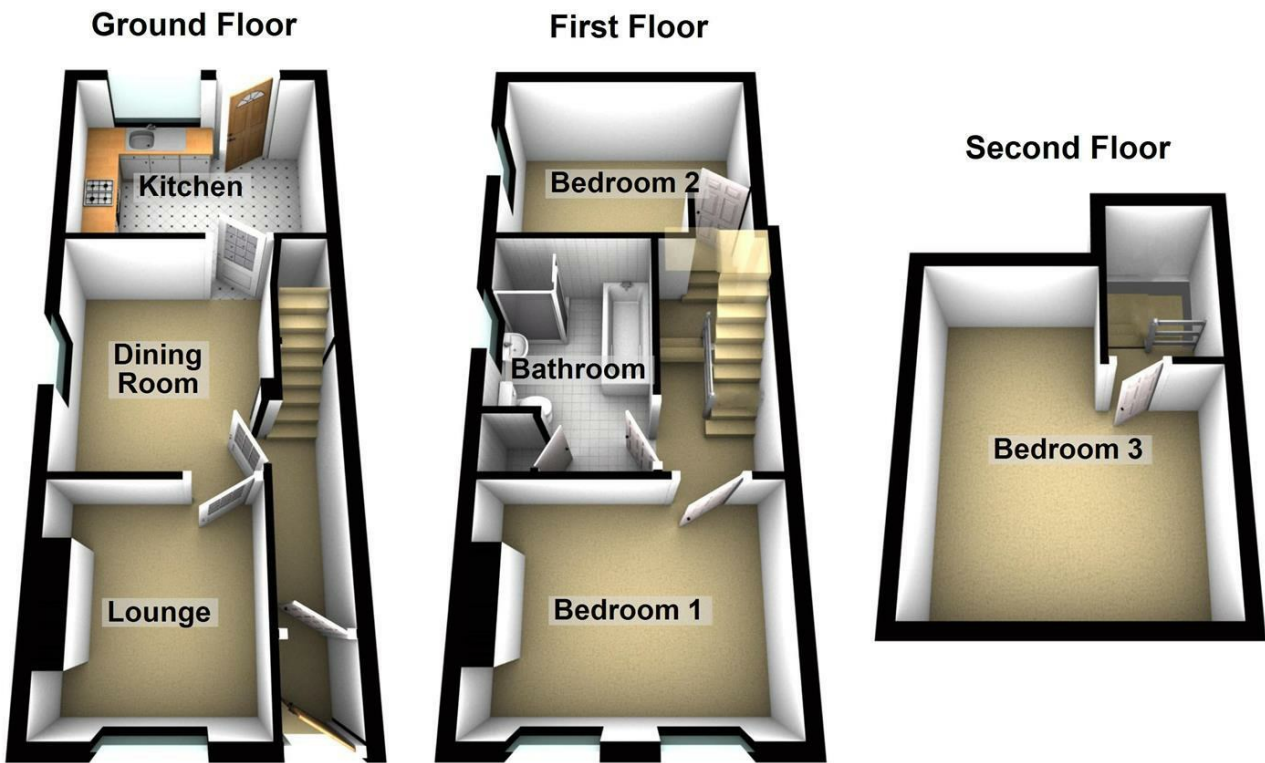

Area Map

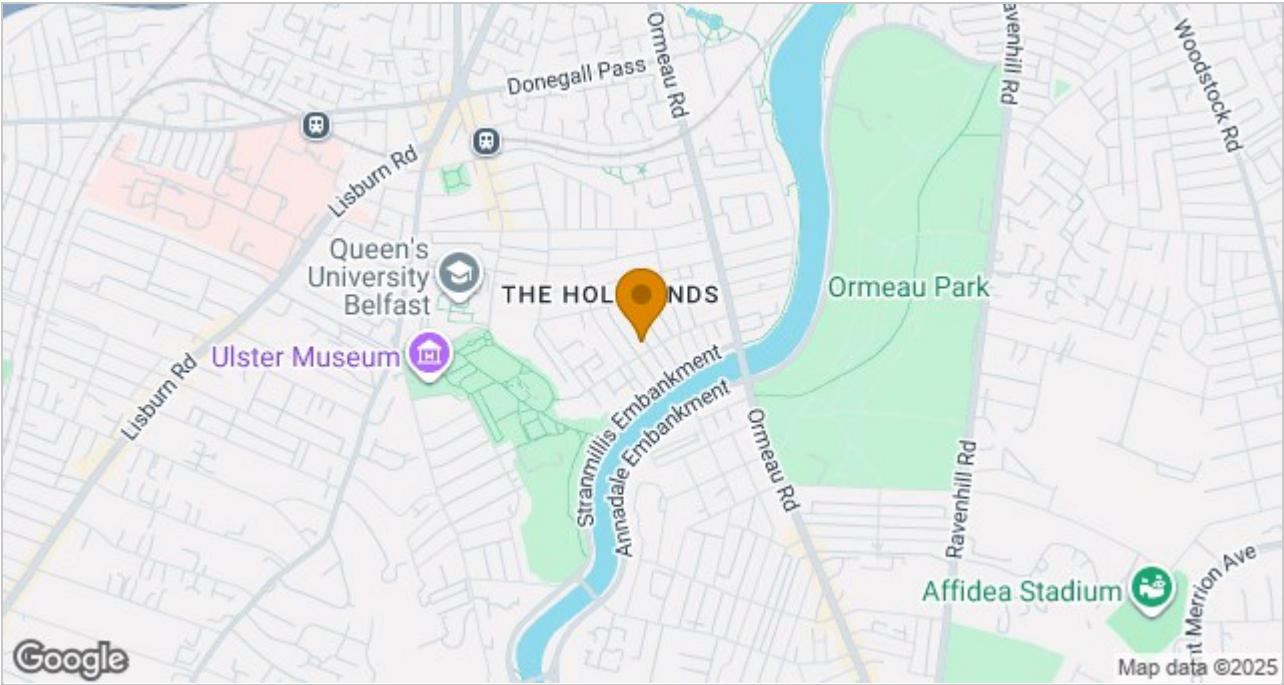

These particulars, whilst believed to be accurate are set out as a general outline only for guidance and do not constitute any part of an offer or contract. Intending purchasers should not rely on them as statements of representation of fact, but must satisfy themselves by inspection or otherwise as to their accuracy. No person in this firms employment has the authority to make or give any representation or warranty in respect of the property.

ULSTERPROPERTYSALES.CO.UK

ANDERSONSTOWN  
028 9060 5200  
BALLYHACKAMORE  
028 9047 1515  
BALLYNAHINCH  
028 9756 1155

BANGOR  
028 9127 1185  
CARRICKFERGUS  
028 9336 5986  
CAVEHILL  
028 9072 9270

DONAGHADEE  
028 9188 8000  
DOWNPATRICK  
028 4461 4101  
FORESTSIDE  
028 9064 1264

GLENGORMLEY  
028 9083 3295  
MALONE  
028 9066 1929  
NEWTOWNARDS  
028 9181 1444

RENTAL DIVISION  
028 9070 1000



Forestsides Estates Ltd; Trading under licence as Ulster Property Sales (Forestsides) Reg. No. NI051121; Registered Office: 9 Upper Crescent, Belfast BT7 1NT ©Ulster Property Sales is a Registered Trademark