



5 Annahugh Hill Loughgall, Armagh, BT61 8DD

Offers over £195,000



5 Annahugh Hill, Loughgall, BT61 8DD

Nestled within the highly regarded Ballyhegan area, this attractive three-bedroom detached home enjoys a peaceful semi-rural setting between Loughgall and Portadown, offering the perfect balance of countryside living with convenient access to local towns and amenities.

The property is well-proportioned throughout, providing comfortable and flexible accommodation that will appeal to a wide range of purchasers, from first-time buyers to growing families. Externally, the home benefits from generous outdoor space, ideal for those seeking privacy and room to enjoy the surroundings.

This is a fantastic opportunity to secure a detached home in a sought-after location, with strong demand for properties of this nature continuing across the area.



Area Map



Floor Plans

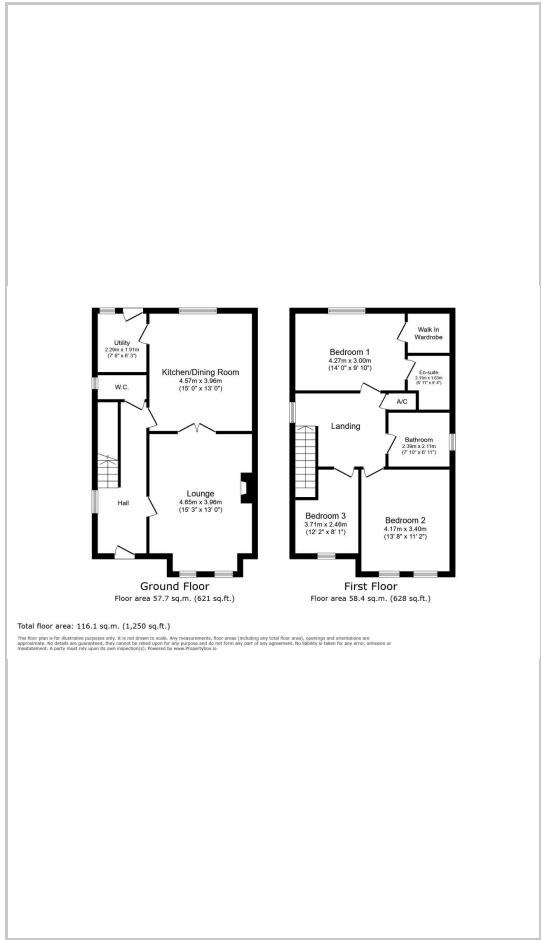

Energy Efficiency Graph

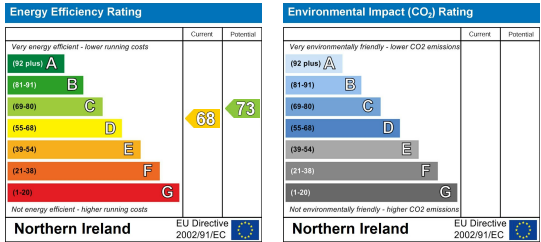

These particulars, whilst believed to be accurate are set out as a general outline only for guidance and do not constitute any part of an offer or contract. Intending purchasers should not rely on them as statements of representation of fact, but must satisfy themselves by inspection or otherwise as to their accuracy. No person in this firm's employment has the authority to make or give any representation or warranty in respect of the property.