

9261 2121
stewartestateagents.com

stewart
estate agents



126 MAGHERACONLUCE ROAD

Annahilt Royal Hillsborough BT26 6AP



Offers around
£119,950







Ground Floor

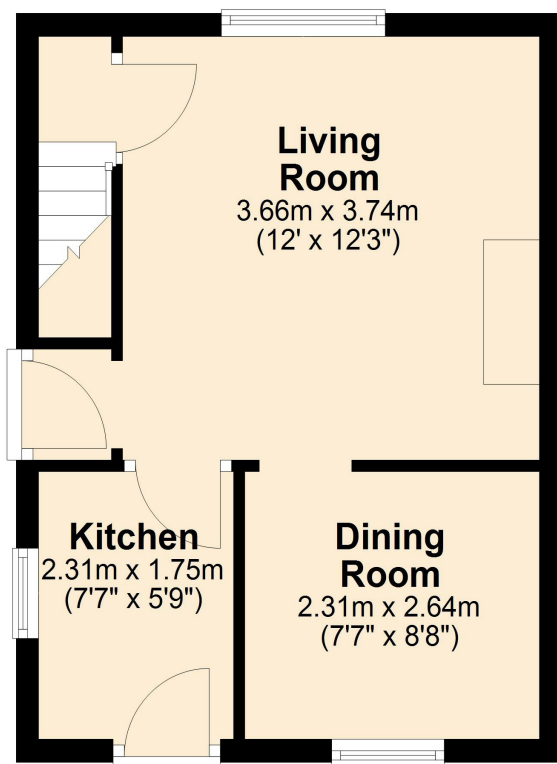

First Floor

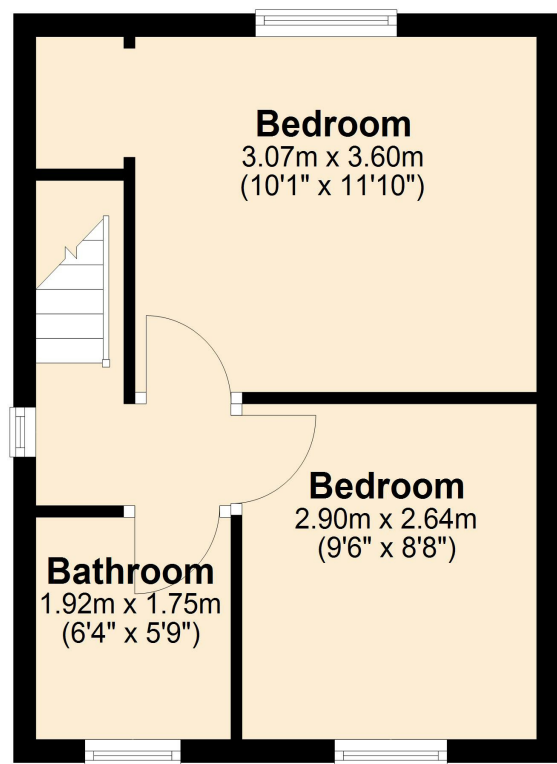

Description

A wonderful opportunity to purchase a semi-detached house with a large rear garden extending to approximately 0.3 acres. The property requires a full renovation and will immediately appeal to a wide spectrum of potential purchasers seeking a development project with potential for extension and indeed the potential for a site in the garden, subject to all planning permissions and necessary consents.

Annahilt is a charming rural hamlet with some local amenities including a shop, primary school, The pheasant restaurant and good road networks for Hillsborough, Lisburn and Ballynahinch.

Viewing by appointment only!

Features:-

- Semi-detached cottage style house requiring renovation
- Two bedrooms, bedroom one with a recess for a wardrobe and a small cast iron fireplace
- Bathroom with bath, WC and wash hand basin
- Entrance porch with a storage cupboard under stairs
- Living room with fireplace
- Separate dining room
- Kitchen with fitted sink unit and cupboards under. Larder cupboard
- Large gardens extending to approximately 0.3 acres
- Gates leading into a driveway

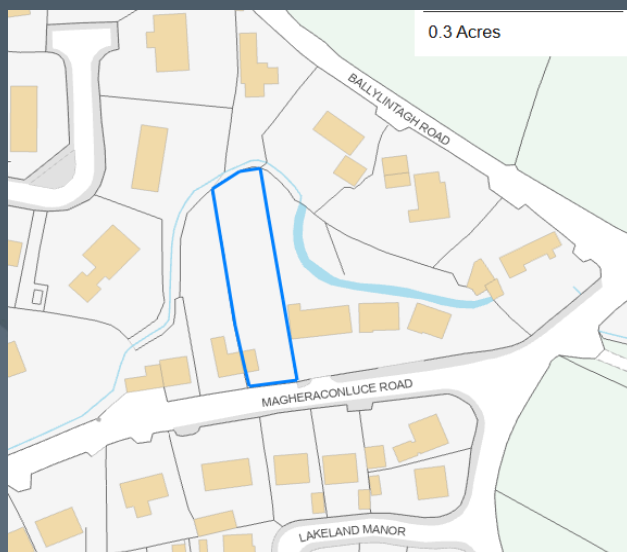

Score	Energy rating	Current	Potential
92+	A		
81-91	B		
69-80	C		75 C
55-68	D		
39-54	E		
21-38	F		
1-20	G	16 G	

These particulars do not constitute any part of an offer or contract. None of the statements contained in these particulars are to be relied on as statements or representations of fact and intending purchasers must satisfy themselves by inspection or otherwise to the correctness of each of the statements contained in these particulars. The vendor does not make or give, and neither Stewart Estate Agents, nor any person in its employment has any authority to make or give, any representation or warranty whatever in relation to this property. Stewart Estate Agents has not tested any equipment, apparatus, fittings or services and cannot verify that these are in working order.