

45 William Street, Portadown, BT62 3NX

Asking Price £100,000

- Prime town centre location
- Commercial unit on William St
- Spacious interior layout
- Converted residential to commercial
- Ideal for business use
- Close to local amenities
- Currently a dentist practice
- Central Portadown location
- Viewing recommended

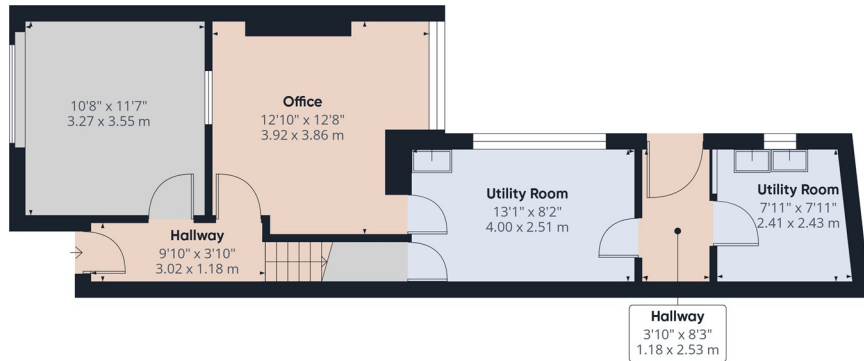

Ground Floor

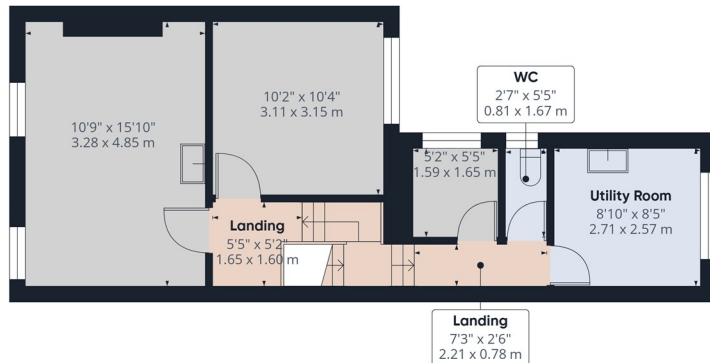

Floor 1

Approximate total area⁽¹⁾
997 ft²
92.7 m²

(1) Excluding balconies and terraces

Calculations reference the RICS IPMS 3C standard. Measurements are approximate and not to scale. This floor plan is intended for illustration only.

GIRAFFE360

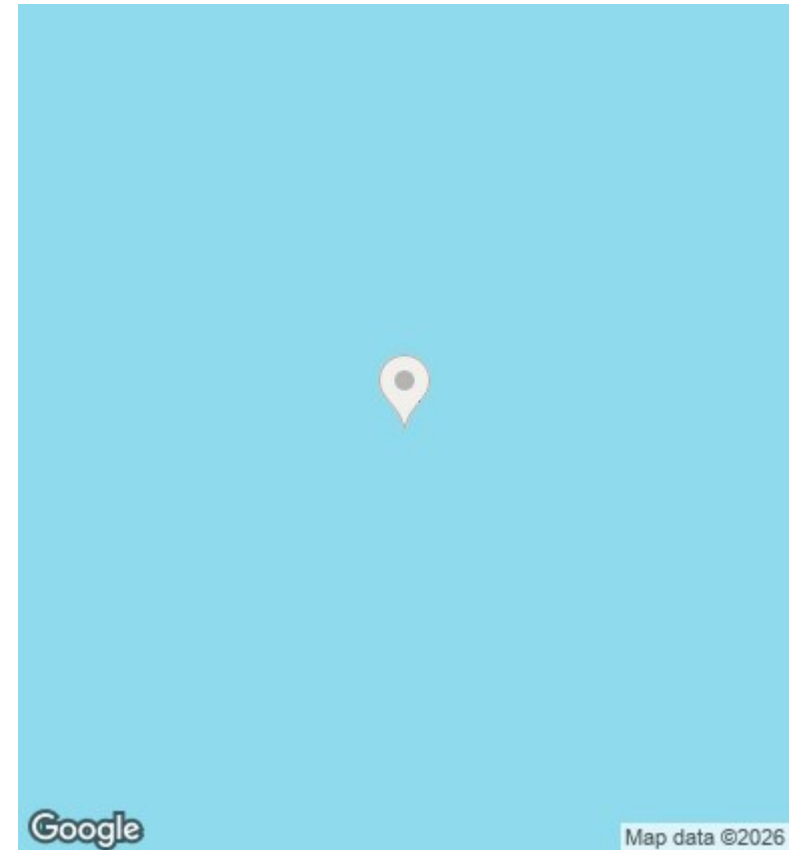

Map data ©2026

Directions

Viewings

Viewings by arrangement only. Call 02838 399911 to make an appointment.

Council Tax Band

Northern Ireland

EPC Rating:

Energy Efficiency Rating		
	Current	Potential
<i>Very energy efficient - lower running costs</i>		
(92 plus) A		
(81-91) B		
(69-80) C		
(55-68) D		
(39-54) E		
(21-38) F		
(1-20) G		
<i>Not energy efficient - higher running costs</i>		
Northern Ireland	EU Directive 2002/91/EC	