

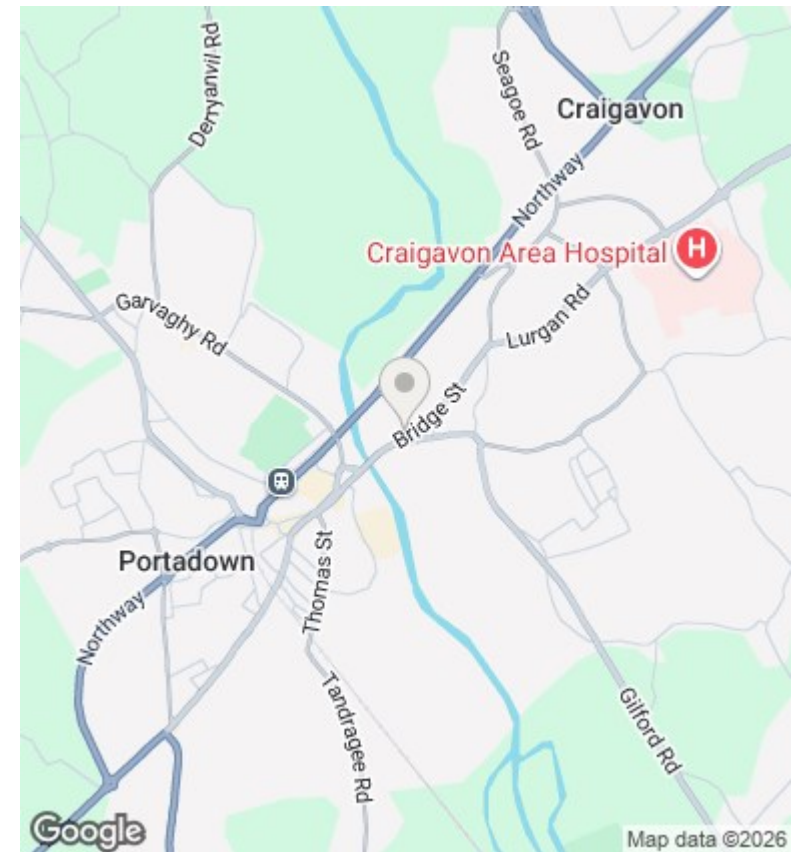

## 6 Watsons Lane, Portadown, Craigavon, County Armagh, BT63

£695 PCM

- Two Bedroom Mid-Terrace Property
- Enclosed Rear Yard
- First floor bathroom suite
- Deposit: £695
- OFCH
- Older terraced house
- Ideal Location Close to Town Centre
- Ground floor reception room
- Viewing recommended

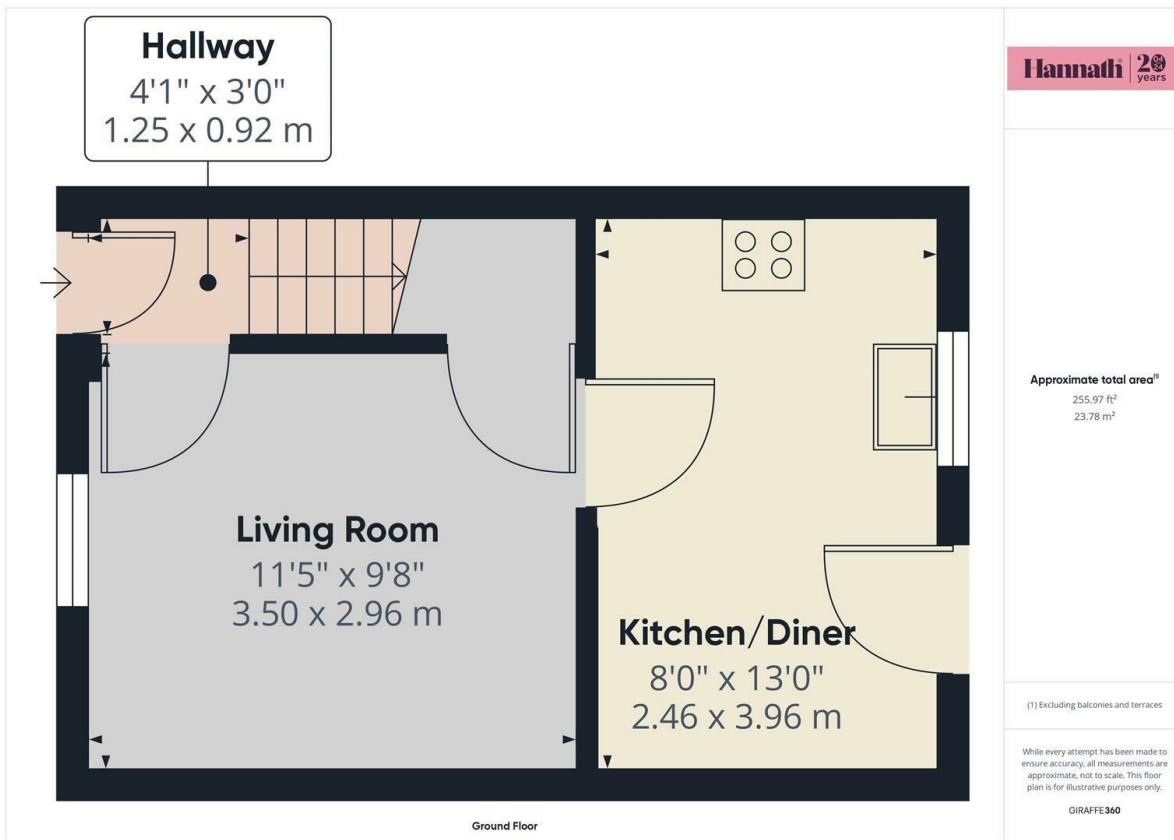

## Directions

Situated in the a popular residential area. The property is within minutes of Craigavon Area hospital, Rushmere shopping centre, Craigavon Omniplex, Portadown town centre, many top schools, restaurants as well as other local amenities.

## Viewings

Viewings by arrangement only. Call 02838 399911 to make an appointment.

## Council Tax Band

Northern Ireland

## EPC Rating:

C

